

pattern pieces

- 1 – body
- 2 – lining

materials needed

- 1/4 yard fabric
- 1/4 yard medium weight fusible interfacing (like Pellon décor bond or craft fuse)
- 1/8 yard interlining
- 7" zipper for view A
- 1/2" button for view B
- 5" length of narrow elastic for view B
- zipper foot for your sewing machine

directions

1. Cut fabric, interfacing and interlining as indicated on each pattern piece. Trim 1/2" off the top edge of the interlining, as indicated on the pattern.
2. Follow manufacturer's directions to apply two layers of medium weight fusible interfacing to the wrong side of the body. Let the first layer cool slightly before applying second layer.
3. Fold under and press 1/2" toward the wrong side along the top edge of the body and lining.

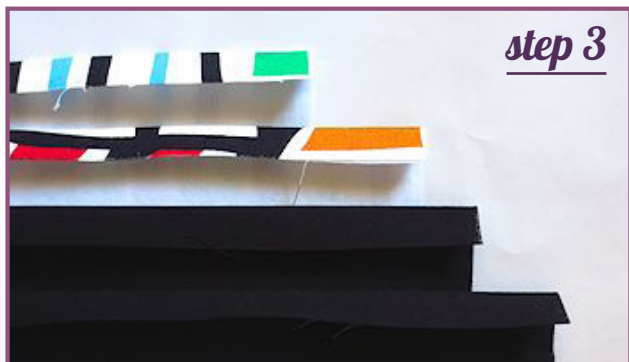

4. Trim away a small square of the interlining at the upper corners on both sides. Position the interlining so that this edge of the interlining aligns with the top folded edge of the lining (see image in step 15).
5. If you are using fusible fleece as interlining, follow manufacturer's directions to apply fleece to the wrong side of the lining. If you are using felt or cotton batting, pin and quilt the interlining to the lining in any design you choose.

(skip to step 13 for view B)

6. For view A, pin the body and lining together, **wrong sides facing**, with top folded edges matching, and raw sides matching.

7. Insert the left side of the zipper tape between the folded top edges of the front of the sleeve, so that the distance between the fold and the zipper teeth is even, and that the zipper pull is 1/2" away from the raw edge. Pin in place. Use a zipper foot to topstitch the zipper in place.



8. Repeat step 7 with the other side of the zipper tape and the back of the sleeve, making sure the raw edges match.

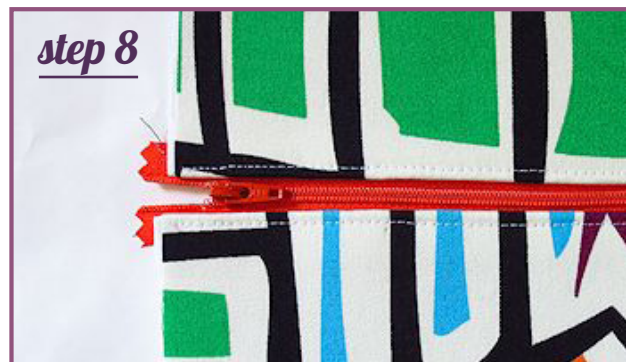

9. With the zipper opened, pin the body to itself and the lining to itself, with right sides facing, making sure raw edges match all the way around.
10. Stitch all the way around using a 3/8" seam allowance, leaving a hole at the bottom of the lining about 3" wide. Backstitch at the beginning and end of the hole, at all four corners, and along the side seams where the body and lining meet. Take care to not stitch over the zipper stops.



11. Trim the corners and the seam allowance all the way around, **except over the hole in the lining!** Turn right side out.