

pattern pieces

- 1 – body
- 2 – pocket backing
- 3 – large pocket
- 4 – medium pocket
- 5 – small pocket

materials needed

- 1 fat quarter (18" x 22") fabric
- 1 fat quarter medium weight fusible interfacing (like Pellon décor bond or craft fuse)
- 10" length of double fold bias tape (regular or extra-wide)
- 1/2" button for view B
- 3.5" length of narrow elastic for view B

directions

1. Cut fabric and interfacing as indicated on each pattern piece. This pattern can be cut on the straight grain or crosswise grain, depending on the print on your fabric. If there is a motif on your fabric you want to feature on the front of your wallet, position the part of pattern piece #1 labeled "front of wallet" over that spot before cutting.
2. Follow manufacturer's directions to apply two layers of medium weight fusible interfacing to the wrong side of the body. Let the first layer cool slightly before applying the second layer.

prepare the pockets

3. Finish the top edges of all three pockets with a narrow hem: fold under and press 1/4" toward the wrong side twice, and then stitch close to folded edge.

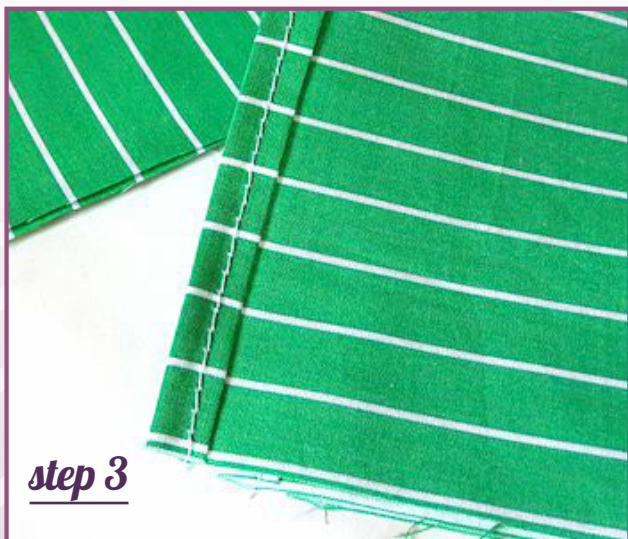

4. Fold the pocket backing in half lengthwise with **wrong sides together** and press flat.
5. Stack the pockets by size on top of the pocket backing, with the largest on the bottom and the smallest on top, and with raw edges matching. Baste all four layers together, 1/8" away from the raw edge. Finish the raw edge with a narrow zig zag stitch.



6. Fold basted pockets and pocket backing in half down the center and finger-press. Stitch in this crease to divide pockets in half. Start at the raw edge and sew towards the folded edge. With the needle down at the top of the pocket backing, lift the presser foot and turn the fabric to sew back towards the raw edge, over the stitch you just made.

